

The background is a solid yellow color. It is decorated with several abstract geometric elements. On the right side, there are large, overlapping shapes in dark blue and light blue, some with white circular cutouts. A green shape is also visible. On the left side, there are smaller blue and green shapes, some with white circles. A white diagonal line runs from the bottom right towards the center. The overall style is modern and graphic.

Telecommunications Asset Alterations

File Name: R:\22 Projects\2207 - BusConnects Galway - Drafts\Road\GEN00 Drawing\B0048\B1-UT_LU-ZZ-DR-CL-0002-0001_LIN07_Divisions Telecommunications.dwg

Disclaimer:
a. © Galway City Council (GCC) 2023. This drawing is confidential and the copyright in it is owned by GCC. This drawing must not be either loaned, copied or otherwise reproduced in whole or in part or used for any purpose without the prior permission of GCC.

b. This drawing is to be used for the design element identified in the titlebox. Other information shown is to be considered indicative only. The drawing is to be read in conjunction with all other relevant design drawings.

c. O.S. data used for plans are printed under © Ordnance Survey Ireland Government of Ireland. All rights reserved. Licence Number 2022/21/CCMA/Galway City Council. All elevations are in metres and relate to OSI Geoid Model (OSGM15) Mean Head. All Co-ordinates are in Irish Transverse Mercator Grid (ITM) as defined by OSI active local GPS station.

d. Information concerning the position of apparatus shown on this drawing is based on drawings supplied by the utility owners and/or the utility works contractor, whilst every care has been taken in the preparation of this drawing, positions should be taken as approximate and are intended for general guidance only and no representation is made by the GCC as to the accuracy, completeness, sufficiency or otherwise of this drawing and the position of the apparatus. The information contained herein does not purport to be comprehensive or final as the apparatus is subject to being altered and/or superseded. Recipients should not rely on this information. Any liabilities are hereby expressly disclaimed.

e. The information contained herein has been provided by the GCC but does not purport to be comprehensive or final. Recipients should not rely on the information. Neither the GCC nor any of its directors, officers, employees, agents, stakeholders or advisers make any representation or warranty as to, or accept any liability or responsibility in relation to, the adequacy, accuracy, reasonableness or completeness of the information provided as part of this document or any matter on which the information is based (including but not limited to loss or damage arising as a result of reliance by recipients on the information or any part of it). Any liabilities are hereby expressly disclaimed.

LEGEND:

	AURORA		EXISTING AURORA NETWORK		EIR CV		EIR NETWORK - PROPOSED DIVERSION		EXISTING KERB LINE
	BT		EXISTING BT NETWORK		VM		VIRGIN MEDIA - PROPOSED DIVERSION		PROPOSED KERB LINE
	COMMS		EXISTING COMMS NETWORK		ENET		ENET - PROPOSED DIVERSION		SITE BOUNDARY LINE
	EIR		EXISTING EIR NETWORK		BT		BT NETWORK - PROPOSED DIVERSION		TEMPORARY LAND ACQUISITION
	ENET		EXISTING ENET NETWORK		BTDA		BT - PROPOSED DIVERSION		
	FB		EXISTING FIBRE GALWAY CITY COUNCIL NETWORK		DUCT		PROPOSED SPARE EIR DUCTING		
	VM		EXISTING VIRGIN MEDIA NETWORK				EXISTING NETWORK TO BE DECOMMISSIONED		

NOTES:
1. UTILITY LOCATIONS ARE INDICATIVE ONLY AND BASED ON UTILITY PROVIDER RECORDS.

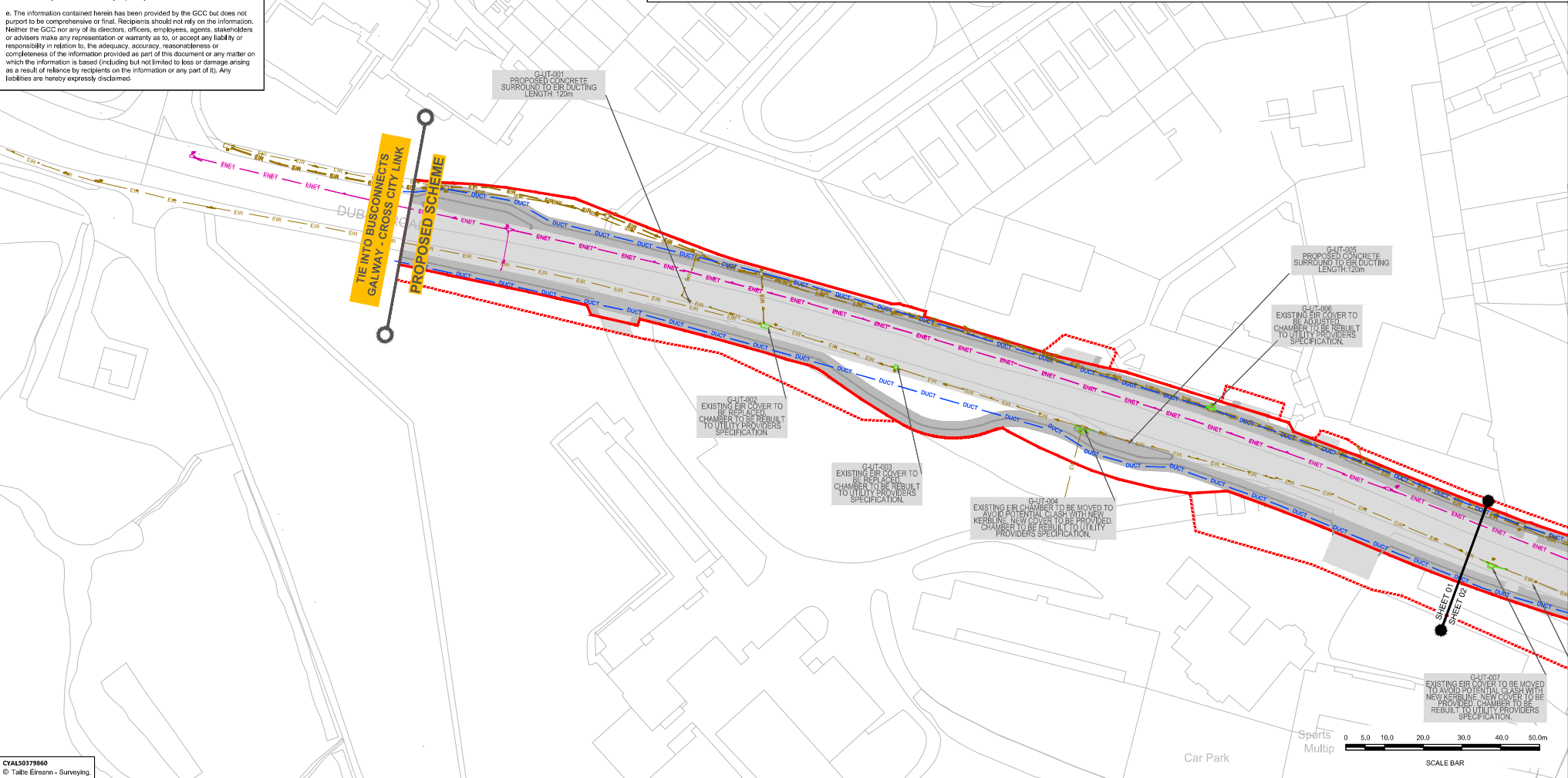

CYAL50379660
© Taithe Eireann - Surveying.



Notes:
DO NOT SCALE, use figured dimensions only.
All levels are referred to Ordnance Survey Datum, Mean Head.
This drawing is the property of Barry Transportation. It is a confidential document and must not be copied, used, or its contents divulged without prior written consent. This document should not be relied on or used in circumstances other than those for which it was originally prepared. Barry Transportation accepts no responsibility for this document to any other party other than the party by whom it was commissioned.

Rev.	Date	Drawn	Description	Chk'd	Asor.
001	06/03/24	QIP	BLUE FOR PLANNING	301	JA

Project Title:	BUSCONNECTS GALWAY - DUBLIN ROAD	Status:	A1
Drawing Title:	UTILITY DIVERSIONS TELECOMMUNICATIONS SHEET 1 OF 11	Rev:	C01
Designed: AC	Drawing No. BCDGR-8TL-UL-T_LU-ZZ-DR-CL-00021		
Drawn: AC	Scale at A1: 1:500		
Approved: JH	Date: OCT 2023		
Reviewed: BCL			

File Name: R:\02 Projects\2007 - Bus Connects Galway - Dublin Road\GEN00 Drawing\B00048-B1-UT_L1_U2-ZZ-06-CL-0002-0001_L1M2_Divisions Telecommunications.dwg

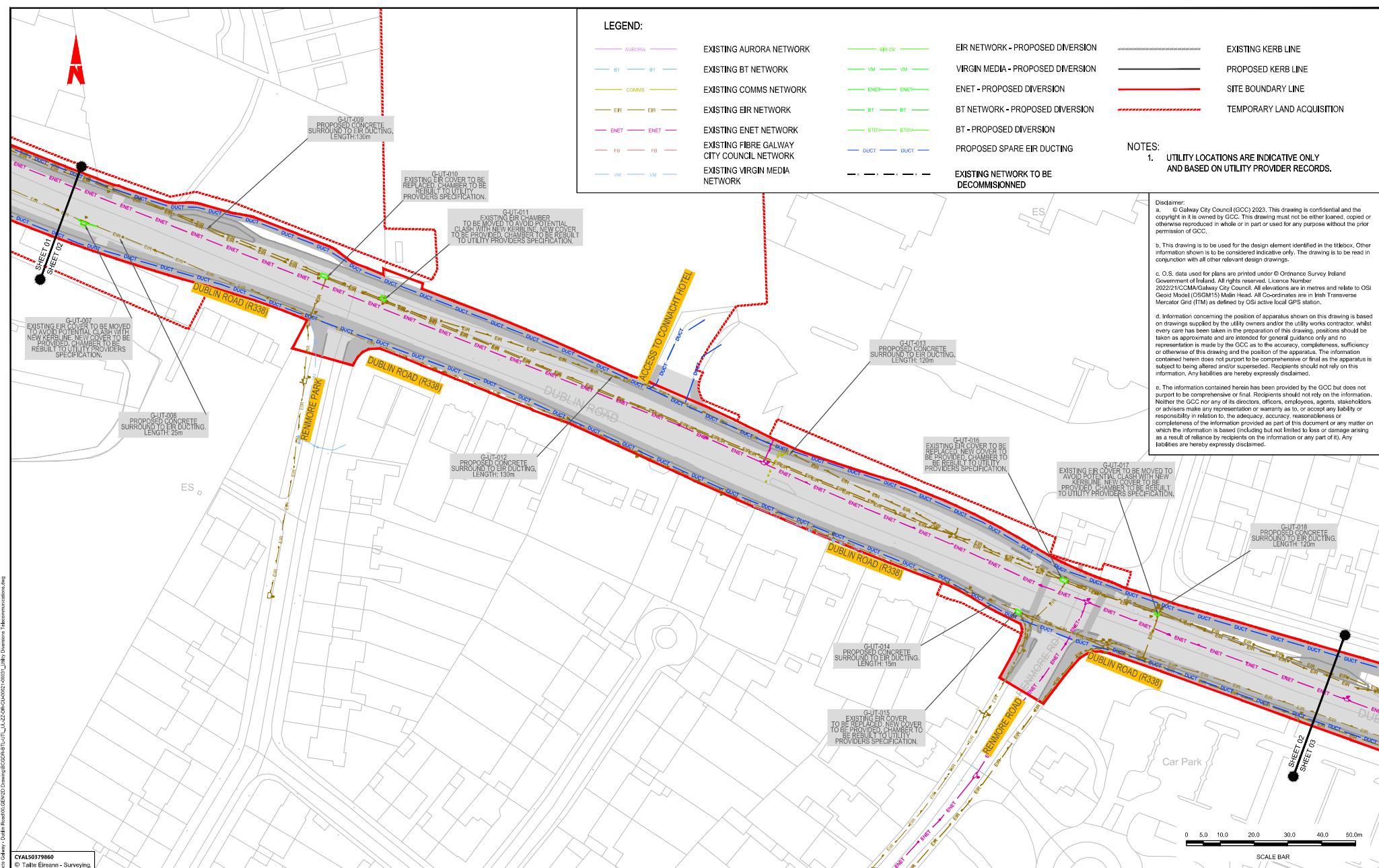

CYAL50379860
© Taithe Eireann - Surveying.

Notes:

DO NOT SCALE. Use figured dimensions only.

All levels are related to Ordnance Survey Datum, Mean Head.

This drawing is the property of Barry Transportation. It is a confidential document and must not be copied, used, or its content divulged without prior written consent. This document should not be relied on or used in circumstances other than those for which it was originally prepared. Barry Transportation accepts no responsibility for the document to any other party other than the party by whom it was commissioned.

Rev.	Date	Drawn	Description	Chk'd	Appr'd
001	06/03/24	GWP	BLUE FOR PLANNING	SOI	JA

Project Title: BUSCONNECTS GALWAY - DUBLIN ROAD

Drawing Title: UTILITY DIVERSIONS TELECOMMUNICATIONS SHEET 2 OF 11

Designed: AC **Drawing No.:** BCDGR-BT-UT_L1_U2-ZZ-0R-CL-00022

Drawn: AC **Scale:** at A1: 1:500

Approved: SOL **Date:** OCT 2023

Reviewed: JN

Status: A1

Rev: C01

File Name: R:\02 Projects\2007 - Bus Connects Galway - Dublin Road\GEN00 Drawing\B00048-B1-UT_L1_U2-ZZ-06-CL-0002-0001_L1M2_Divisions Telecommunications.dwg

File Name: R:\22 Projects\2007 - BusConnects Galway - Dublin Road\GEN00 Drawing\B0048\B1-UT_L1_U22-DR-CL-0002-0001_U187_Divisions Telecommunications.dwg

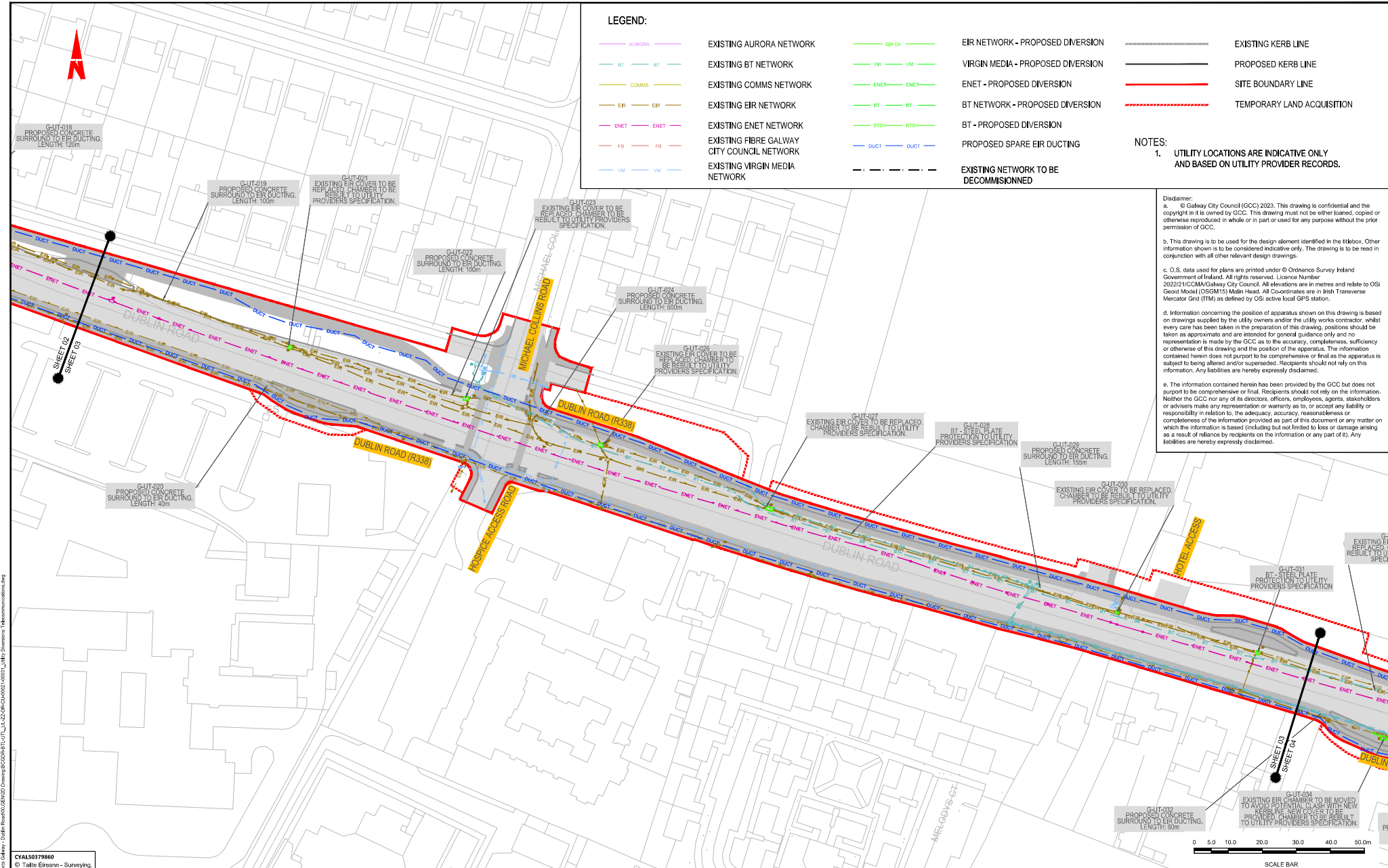

LEGEND:

	AURORA		EIR CV		EIR NETWORK - PROPOSED DIVERSION
	BT		VM		VIRGIN MEDIA - PROPOSED DIVERSION
	COMMS		ENET		ENET - PROPOSED DIVERSION
	EIR		BT		BT NETWORK - PROPOSED DIVERSION
	ENET		BTDA		BT - PROPOSED DIVERSION
	FIB		DUCT		PROPOSED SPARE EIR DUCTING
	VM				EXISTING NETWORK TO BE DECOMMISSIONED

NOTES:

1. UTILITY LOCATIONS ARE INDICATIVE ONLY AND BASED ON UTILITY PROVIDER RECORDS.

Disclaimer:

a. © Galway City Council (GCC) 2023. This drawing is confidential and the copyright in it is owned by GCC. This drawing must not be either loaned, copied or otherwise reproduced in whole or in part or used for any purpose without the prior permission of GCC.

b. This drawing is to be used for the design element identified in the titlebox. Other information shown is to be considered indicative only. The drawing is to be read in conjunction with all other relevant design drawings.

c. O.S. data used for plans are printed under © Ordnance Survey Ireland Government of Ireland. All rights reserved. Licence Number: 2022/21/GCM/Galway City Council. All elevations are in metres and relate to OSI Geoid Model (OSGM15) Mean Head. All Co-ordinates are in Irish Transverse Mercator Grid (ITM) as defined by OSI active local GPS station.

d. Information concerning the position of apparatus shown on this drawing is based on drawings supplied by the utility owners and/or the utility works contractor, whilst every care has been taken in the preparation of this drawing, positions should be taken as approximate and are intended for general guidance only and no representation is made by the GCC as to the accuracy, completeness, sufficiency or otherwise of this drawing and the position of the apparatus. The information contained herein does not purport to be comprehensive or final as the apparatus is subject to being altered and/or superseded. Recipients should not rely on this information. Any liabilities are hereby expressly disclaimed.

e. The information contained herein has been provided by the GCC but does not purport to be comprehensive or final. Recipients should not rely on the information. Neither the GCC nor any of its directors, officers, employees, agents, stakeholders or advisers make any representation or warranty as to, or accept any liability or responsibility in relation to, the adequacy, accuracy, reasonableness or completeness of the information provided as part of this document or any matter on which the information is based (including but not limited to loss or damage arising as a result of reliance by recipients on the information or any part of it). Any liabilities are hereby expressly disclaimed.

DO NOT SCALE. Use figured dimensions only.

All levels are referred to Ordnance Survey Datum, Mean Head.

This drawing is the property of Barry Transportation. It is a confidential document and must not be copied, used, or its contents divulged without prior written consent. This document should not be relied on or used in circumstances other than those for which it was originally prepared. Barry Transportation accepts no responsibility for this document to any other party other than the party by whom it was commissioned.

Rev.	Date	Drawn	Description	Chk'd	App'd
001	06/03/24	GWP	BLUE FOR PLANNING	301	UN

Project Title:	BUSCONNECTS GALWAY - DUBLIN ROAD		Status:	A1
Drawing Title:	UTILITY DIVERSIONS TELECOMMUNICATIONS SHEET 3 OF 11		Rev:	C01
Designed: AC	Drawing No.	BCDGR-BT1-UT_L1_U22-DR-CL-00023		
Drawn: AC	Scale at A1:	1:500		
Approved: SOL	Reviewed: JH	Date: OCT 2023		

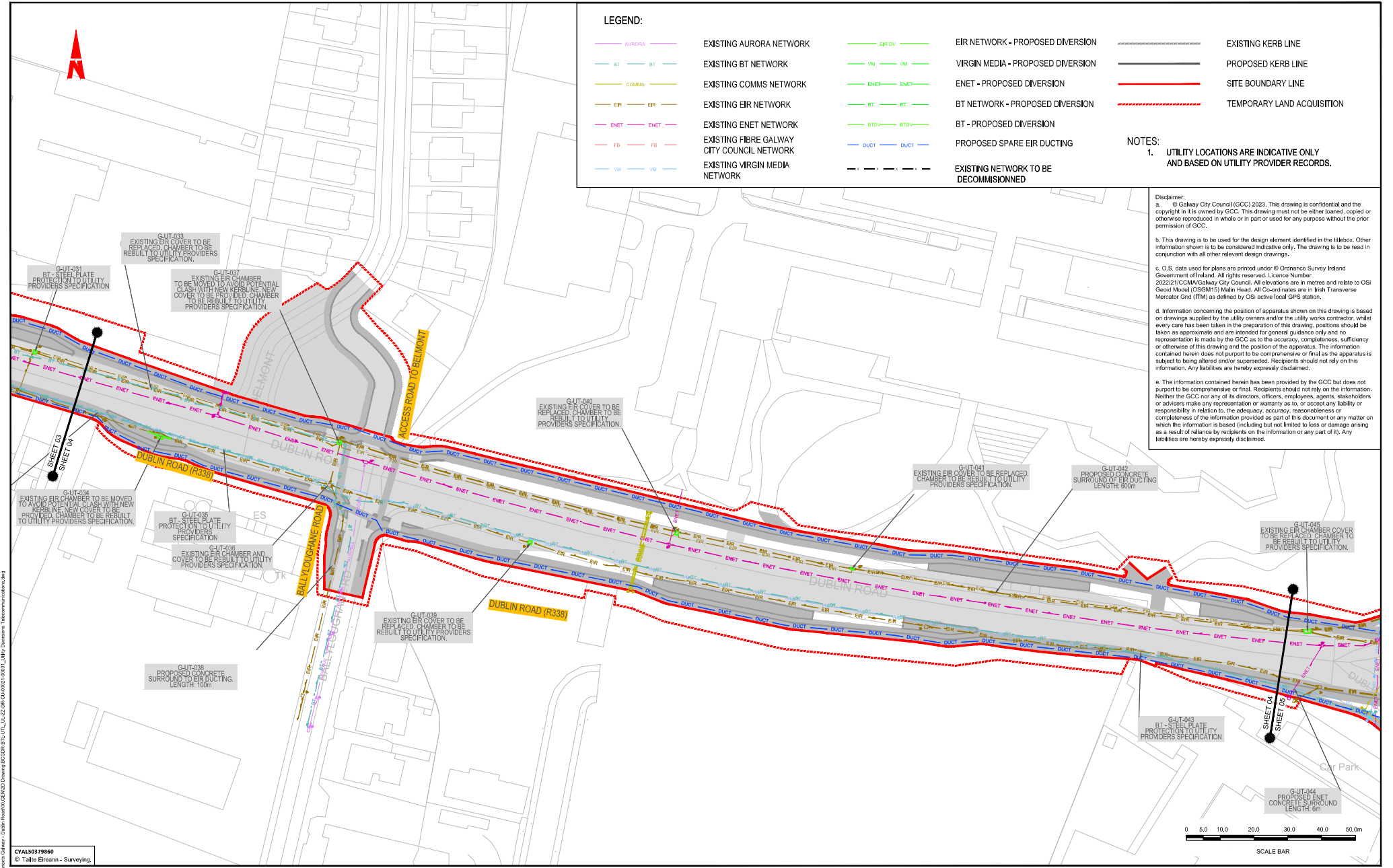

DO NOT SCALE. Use figured dimensions only.

All levels are referred to Ordnance Survey Datum, Mean High.

This drawing is the property of Barry Transportation. It is a confidential document and must not be copied, used, or its contents divulged without prior written consent. This document should not be relied on or used in circumstances other than those for which it was originally prepared. Barry Transportation accepts no responsibility for the document to any other party other than the party by whom it was commissioned.

Rev.	Date	Drawn	Description	Chk'd	App'd
001	06/03/24	GWP	BLUE FOR PLANNING	301	UN

Project Title: BUSCONNECTS GALWAY - DUBLIN ROAD		Status: A1
Drawing Title: UTILITY DIVERSIONS TELECOMMUNICATIONS SHEET 4 OF 11		Rev: C01
Designed: AC	Drawing No. BCDGR-8T1-UL-T_U-22-ZR-CL-00024	
Drawn: AC	Scale at A1: 1:500	
Approved: SOL	Date: OCT 2023	
Reviewed: JH		

File Name: R:\22 Projects\20407 - Bus Connects Galway - Dublin Road\02_GEND Drawing\B0048-BT-UT-T_U-22-ZR-CL-0002-0001_UMB_Diversion Telecommunications.dwg
CYAL50379860
© Tallie Eireann - Surveying.

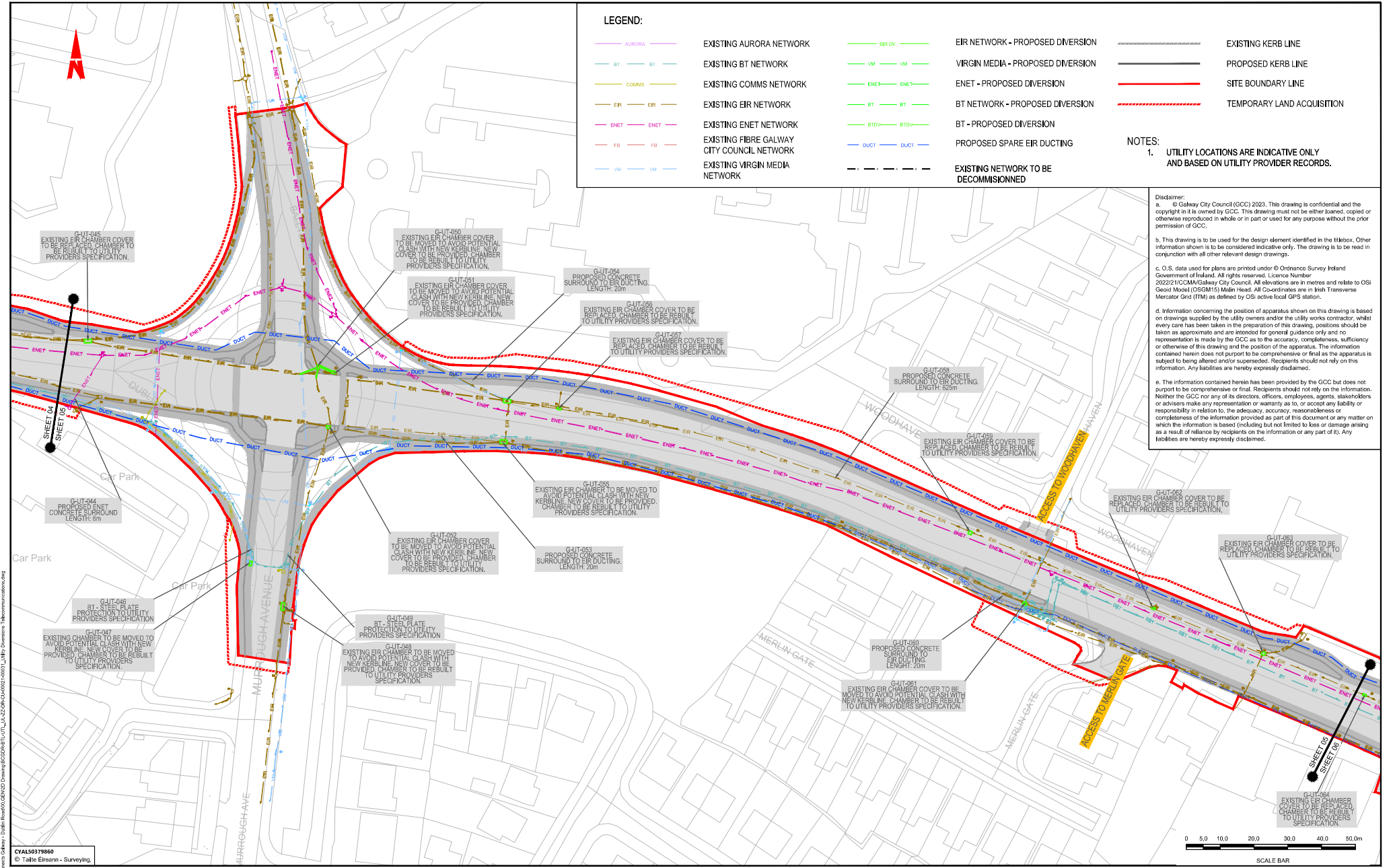

DO NOT SCALE, use figured dimensions only.
All levels are referred to Ordnance Survey Datum, Mean Head.

This drawing is the property of Barry Transportation. It is a confidential document and must not be copied, used, or its content divulged without prior written consent. This document should not be relied on or used in circumstances other than those for which it was originally prepared. Barry Transportation accepts no responsibility for this document to any other party other than the party by whom it was commissioned.

Rev.	Date	Drawn	Description	Chk'd	Asor
001	06/03/24	GWP	ISSUE FOR PLANNING	301	UN

Project Title:	BUSCONNECTS GALWAY - DUBLIN ROAD		Status:	A1
Drawing Title:	UTILITY DIVERSIONS TELECOMMUNICATIONS SHEET 5 OF 11		Rev:	C01
Designed: AC	Drawing No.	BCDGR-8T1-ULI-T_UJ-22-DR-CL-00025		
Drawn: AC	Scale at A1:	1:500		
Approved: SOL	Reviewed: JH	Date: OCT 2023		

File Name: R:\02 Projects\2040 - Bus Connects Galway - Dublin Road\02-GEN-00 Drawing\02-GEN-00-ULI-T_UJ-22-DR-CL-0002-0001_UMI-2 Dimensions Telecommunications.dwg

File Name: R:\22 Projects\2027 - BusConnects Galway - Drafts\Road\GEN00 Drawing\B04R-UT_LU_ZZ-DR-CL-0002-0001_UMR17_Diversion Telecommunications.dwg

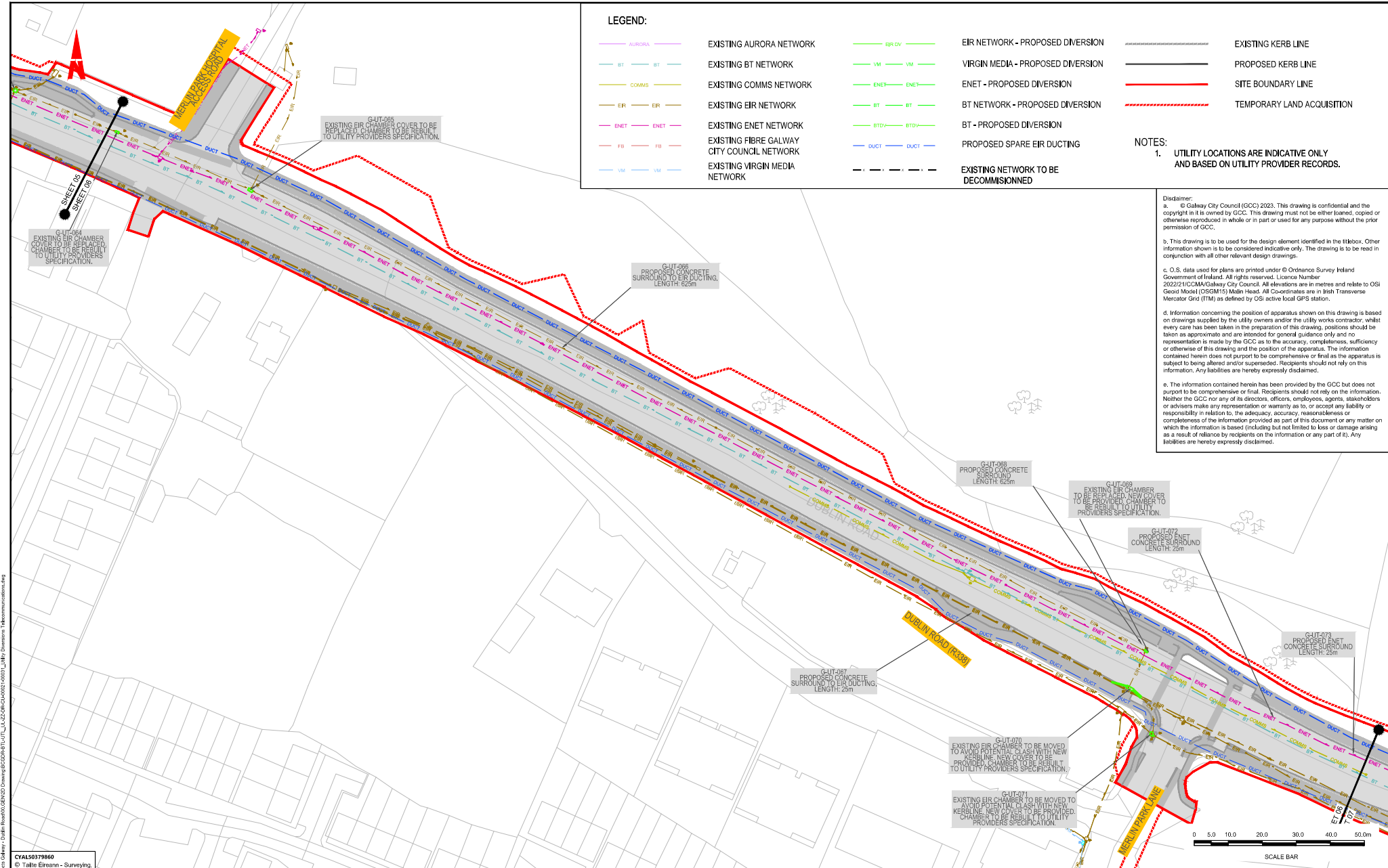

CYAL50379860
© Taithe Éireann - Surveying.

Notes:

DO NOT SCALE. Use figured dimensions only.

All levels are referred to Ordnance Survey Datum, Mean High.

This drawing is the property of Barry Transportation. It is a confidential document and must not be copied, used, or its contents divulged without prior written consent. This document should not be relied on or used in circumstances other than those for which it was originally prepared. Barry Transportation accepts no responsibility for this document to any other party other than the party by whom it was commissioned.

Rev.	Date	Drawn	Description	Chk'd	Asst
001	26/03/24	GWP	BIDULE FOR PLANNING	301	UN

Project Title: BUSCONNECTS GALWAY - DUBLIN ROAD		Status: A1
Drawing Title: UTILITY DIVERSIONS TELECOMMUNICATIONS SHEET 6 OF 11		Rev: C01
Designed: AC	Drawing No: BCDGR-8T1-UT_LU_ZZ-DR-CL-000208	Rev: C01
Drawn: AC	Scale at A1: 1:500	
Approved: SOL	Date: OCT 2023	
Reviewed: JH	Date: OCT 2023	

File Name: R:\22 Projects\2027 - BusConnects Galway - Drafts\Road\GEN00 Drawing\B04R-UT_LU_ZZ-DR-CL-0002-0001_UMR17_Diversion Telecommunications.dwg

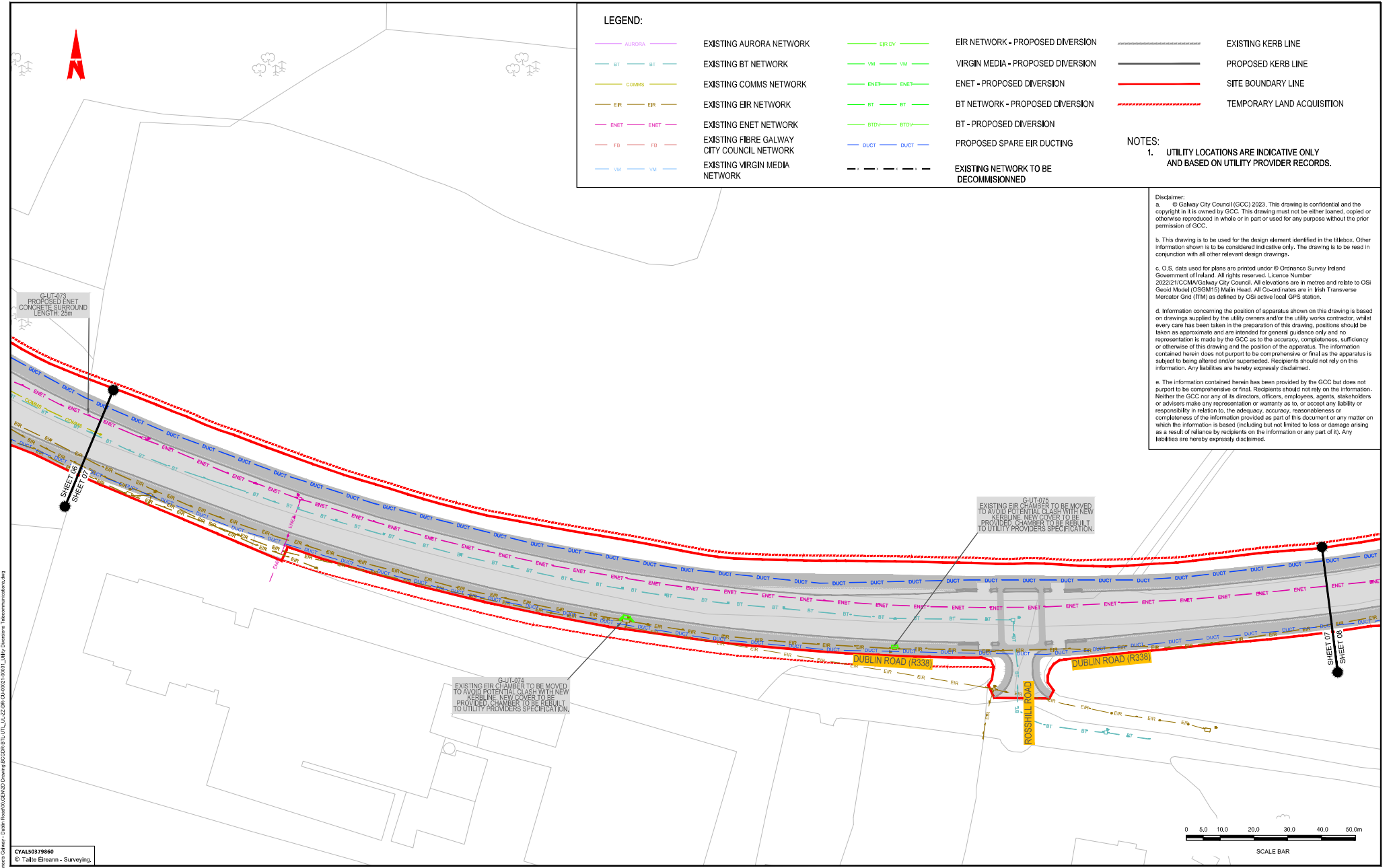

Notes:

DO NOT SCALE. Use figured dimensions only.

All levels are referred to Ordnance Survey Datum, Mean High.

This drawing is the property of Barry Transportation. It is a confidential document and must not be copied, used, or its contents divulged without prior written consent. This document should not be relied on or used in circumstances other than those for which it was originally prepared. Barry Transportation accepts no responsibility for the document to any other party other than the party by whom it was commissioned.

Rev.	Date	Drawn	Description	Chk'd	App'd
001	06/03/24	GWP	BLUE FOR PLANNING	SOI	JA

Project Title:		BUSCONNECTS GALWAY - DUBLIN ROAD		Status:
Drawing Title:		UTILITY DIVERSIONS TELECOMMUNICATIONS SHEET 7 OF 11		A1
Designed: AC	Drawing No.	BCDGR-8T1-UL-T_U-22-DR-CL-00027		Rev: C01
Approved: SOL	Scale at A1:	1:500		
Reviewed: JN	Date:	OCT 2023		

File Name: R:\22 Projects\2040 - Bus Connects Galway - Dublin Road\02_GEND Drawing\8T1-UL-T_U-22-DR-CL-00027-0001_UMB_Diversion Telecommunications.dwg

File Name: R:\22 Projects\2027 - BusConnects Galway - Drafts\Road\GEN03 Drawing\B0304R-1-UT_LU-ZZ-DR-CLU-0002-0001_1.MXD; Division: Telecommunications.dwg

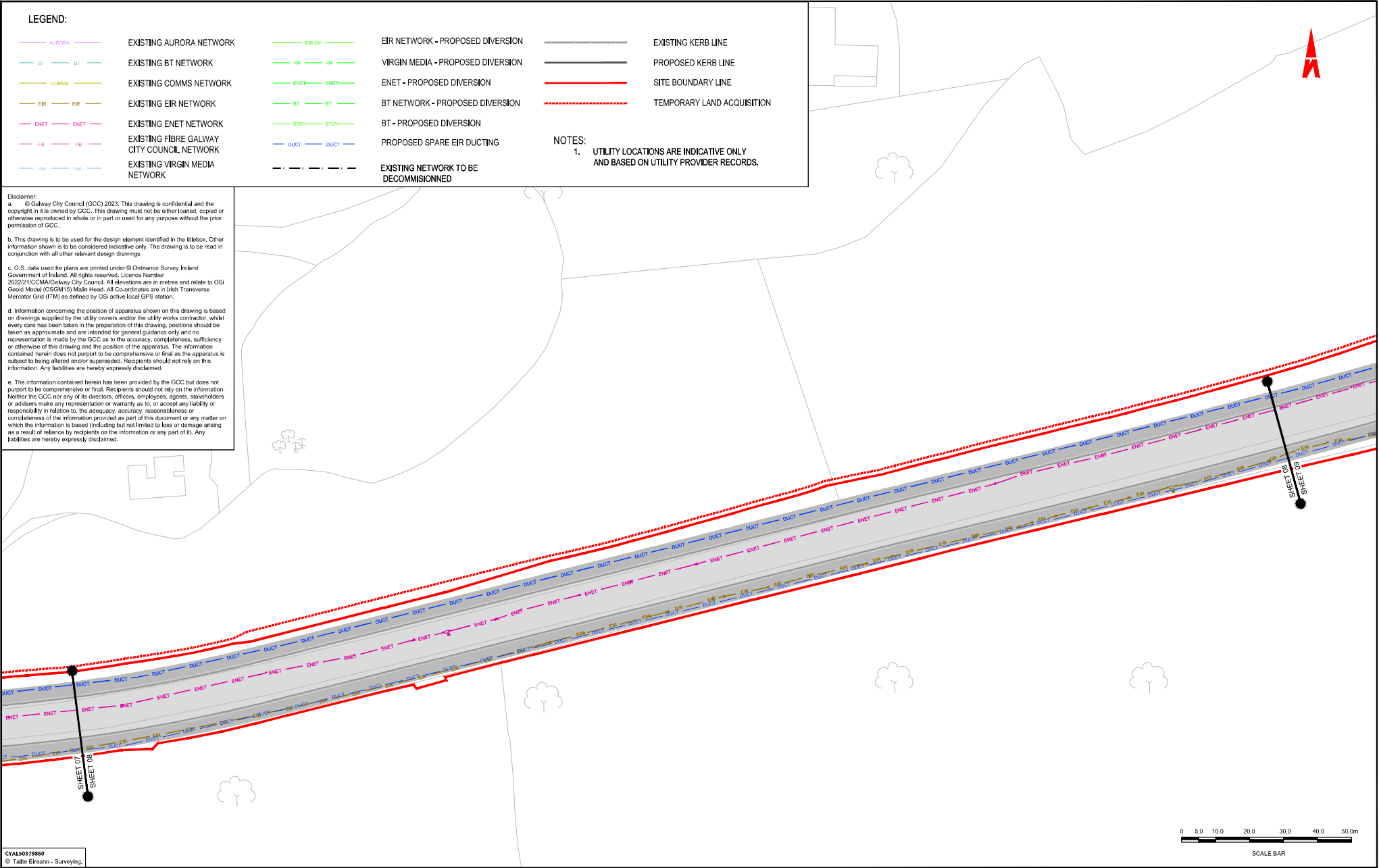

CYAL50379860
© Taithe Éireann - Surveying.



Notes:

DO NOT SCALE. Use figured dimensions only.

All levels are referred to Ordnance Survey Datum, Mean Head.



















This drawing is the property of Barry Transportation. It is a confidential document and must not be copied, used, or its contents divulged without prior written consent. This document should not be relied on or used in circumstances other than those for which it was originally prepared. Barry Transportation accepts no responsibility for the document to any other party other than the party by whom it was commissioned.

Rev.	Date	Drawn	Description	Check	Assn.
001	06/03/24	GP	BLUE FOR PLANNING	SOI	JA

Project Title: BUSCONNECTS GALWAY - DUBLIN ROAD		Status: A1
Drawing Title: UTILITY DIVERSIONS TELECOMMUNICATIONS SHEET 8 OF 11		
Designed: AC	Drawing No: BCDGR-0TL-UL-LU-ZZ-DR-CLU-00028	Rev: C01
Drawn: AC	Scale at A1: 1:500	
Approved: SOL	Date: OCT 2023	
Reviewed: JN		

File Name: R:\22 Projects\2007 - BusConnects Galway - Drafts\001\GEN000 Drawing\B0004-R1-UT_L1_U-22-DR-CL-0002-0001_UMR1 Dimensions Telecommunications.dwg

LEGEND:

	AURORA	EXISTING AURORA NETWORK		EIR DV	EIR NETWORK - PROPOSED DIVERSION		EXISTING KERB LINE
	BT	EXISTING BT NETWORK		VM	VIRGIN MEDIA - PROPOSED DIVERSION		PROPOSED KERB LINE
	COMMS	EXISTING COMMS NETWORK		ENET	ENET - PROPOSED DIVERSION		SITE BOUNDARY LINE
	EIR	EXISTING EIR NETWORK		BT	BT NETWORK - PROPOSED DIVERSION		TEMPORARY LAND ACQUISITION
	ENET	EXISTING ENET NETWORK		BT DV	BT - PROPOSED DIVERSION		
	FIB	EXISTING FIBRE GALWAY CITY COUNCIL NETWORK		DUCT	PROPOSED SPARE EIR DUCTING		
	VM	EXISTING VIRGIN MEDIA NETWORK			EXISTING NETWORK TO BE DECOMMISSIONED		

NOTES:
1. UTILITY LOCATIONS ARE INDICATIVE ONLY AND BASED ON UTILITY PROVIDER RECORDS.

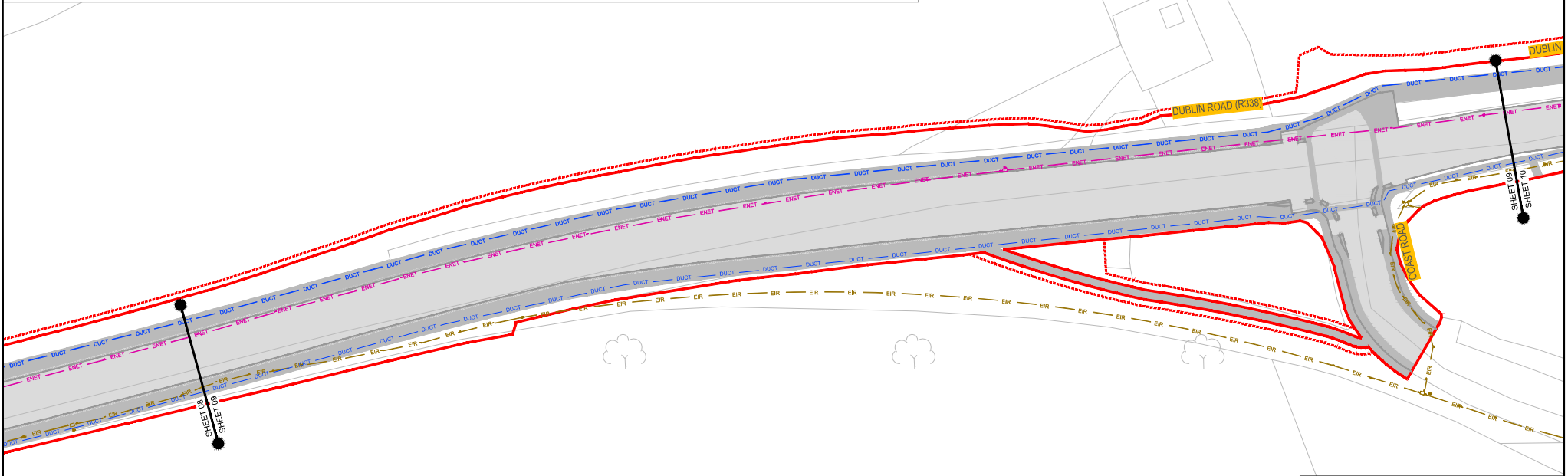

Disclaimer:
a. © Galway City Council (GCC) 2023. This drawing is confidential and the copyright in it is owned by GCC. This drawing must not be either loaned, copied or otherwise reproduced in whole or in part or used for any purpose without the prior permission of GCC.
b. This drawing is to be used for the design element identified in the titlebox. Other information shown is to be considered indicative only. The drawing is to be read in conjunction with all other relevant design drawings.
c. O.S. data used for plans are printed under © Ordnance Survey Ireland Government of Ireland. All rights reserved. Licence Number 2022/21/COMA/Galway City Council. All elevations are in metres and relate to OSI Geoid Model (OSGM15) Mean Head. All Co-ordinates are in Irish Transverse Mercator Grid (ITM) as defined by OSI active local GPS station.
d. Information concerning the position of apparatus shown on this drawing is based on drawings supplied by the utility owners and/or the utility works contractor, whilst every care has been taken in the preparation of this drawing, positions should be taken as approximate and are intended for general guidance only and no representation is made by the GCC as to the accuracy, completeness, sufficiency or otherwise of this drawing and the position of the apparatus. The information contained herein does not purport to be comprehensive or final as the apparatus is subject to being altered and/or superseded. Recipients should not rely on this information. Any liabilities are hereby expressly disclaimed.
e. The information contained herein has been provided by the GCC but does not purport to be comprehensive or final. Recipients should not rely on the information. Neither the GCC nor any of its directors, officers, employees, agents, stakeholders or advisers make any representation or warranty as to, or accept any liability or responsibility in relation to, the adequacy, accuracy, reasonableness or completeness of the information provided as part of this document or any matter on which the information is based (including but not limited to loss or damage arising as a result of reliance by recipients on the information or any part of it). Any liabilities are hereby expressly disclaimed.

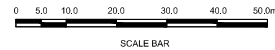

CYAL50379860
© Taithe Éireann - Surveying.







Notes:
DO NOT SCALE. Use figured dimensions only.
All levels are referred to Ordnance Survey Datum, Mean Head.
This drawing is the property of Barry Transportation. It is a confidential document and must not be copied, used, or its contents divulged without prior written consent. This document should not be relied on or used in circumstances other than those for which it was originally prepared. Barry Transportation accepts no responsibility for the document to any other party other than the party by whom it was commissioned.

Rev.	Date	Drawn	Description	Chkd	Asmt
001	26/03/24	QIP	BLUE FOR PLANNING	301	UN

Project Title:	BUSCONNECTS GALWAY - DUBLIN ROAD	Status:	A1
Drawing Title:	UTILITY DIVERSIONS TELECOMMUNICATIONS SHEET 9 OF 11	Rev:	C01
Designed: AC	Drawing No. BCDGR-8T1-UL1_U-22-DR-CL-00029		
Drawn: AC	Scale at A1: 1:500		
Approved: SOL	Date: OCT 2023		
Reviewed: JN			

LEGEND:

AURORA
 BT
 COMMS
 EIR
 ENET
 FB
 VM

EXISTING AURORA NETWORK
 EXISTING BT NETWORK
 EXISTING COMMS NETWORK
 EXISTING EIR NETWORK
 EXISTING ENET NETWORK
 EXISTING FIBRE GALWAY
 CITY COUNCIL NETWORK
 EXISTING VIRGIN MEDIA
 NETWORK

The diagram illustrates the proposed diversions for various networks. It consists of a series of horizontal lines, each representing a different network. The lines are color-coded: green for EIR, Virgin Media, ENET, and BT; blue for BTDX and the proposed spare EIR ducting; and black for the existing network to be decommissioned. The lines are arranged in a vertical stack, with each line having a label on the left and right sides. The labels are: EIR DIV, VIRGIN MEDIA - PROPOSED DIVERSION, ENET - PROPOSED DIVERSION, BT NETWORK - PROPOSED DIVERSION, BT - PROPOSED DIVERSION, PROPOSED SPARE EIR DUCTING, and EXISTING NETWORK TO BE DECOMMISSIONED.

Network	Color	Label
EIR	Green	EIR DIV
VIRGIN MEDIA	Green	VIRGIN MEDIA - PROPOSED DIVERSION
ENET	Green	ENET - PROPOSED DIVERSION
BT	Green	BT NETWORK - PROPOSED DIVERSION
BTDX	Blue	BT - PROPOSED DIVERSION
EIR	Blue	PROPOSED SPARE EIR DUCTING
EXISTING NETWORK	Black	EXISTING NETWORK TO BE DECOMMISSIONED

EXISTING KERB LINE
PROPOSED KERB LINE
SITE BOUNDARY LINE
TEMPORARY LAND ACQUISITION

NOTES:
1. UTILITY LOCATIONS ARE INDICATIVE ONLY
AND BASED ON UTILITY PROVIDER RECORDS.

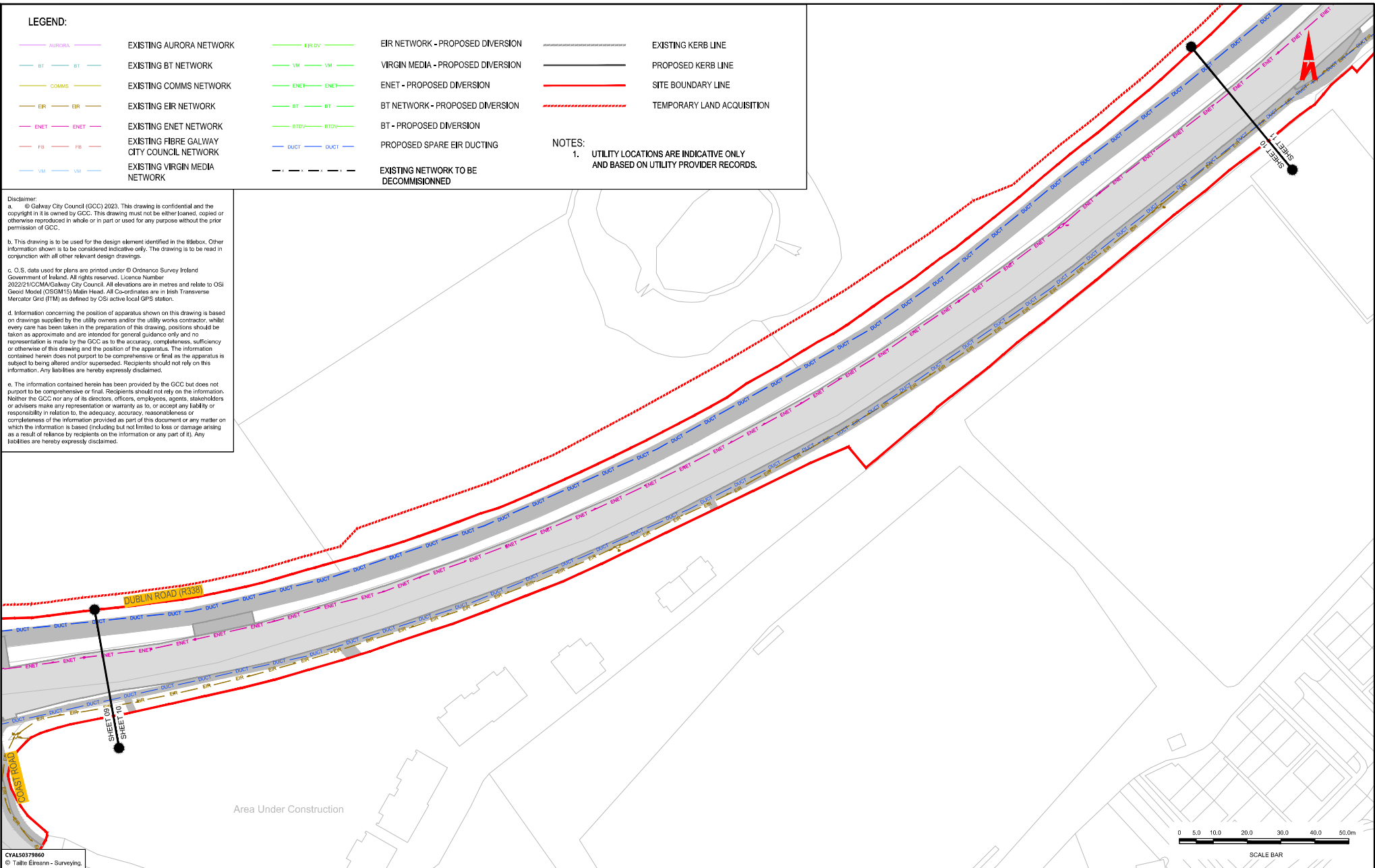
[illegible]

File Name: R:\22 Projects\207 - BusConnects Galway - Dublin Road\GEN00 Drawing\B004R-81-T_U_L-22-DR-CL-00031-00001_11M7-Drawings\Telecommunications.dwg

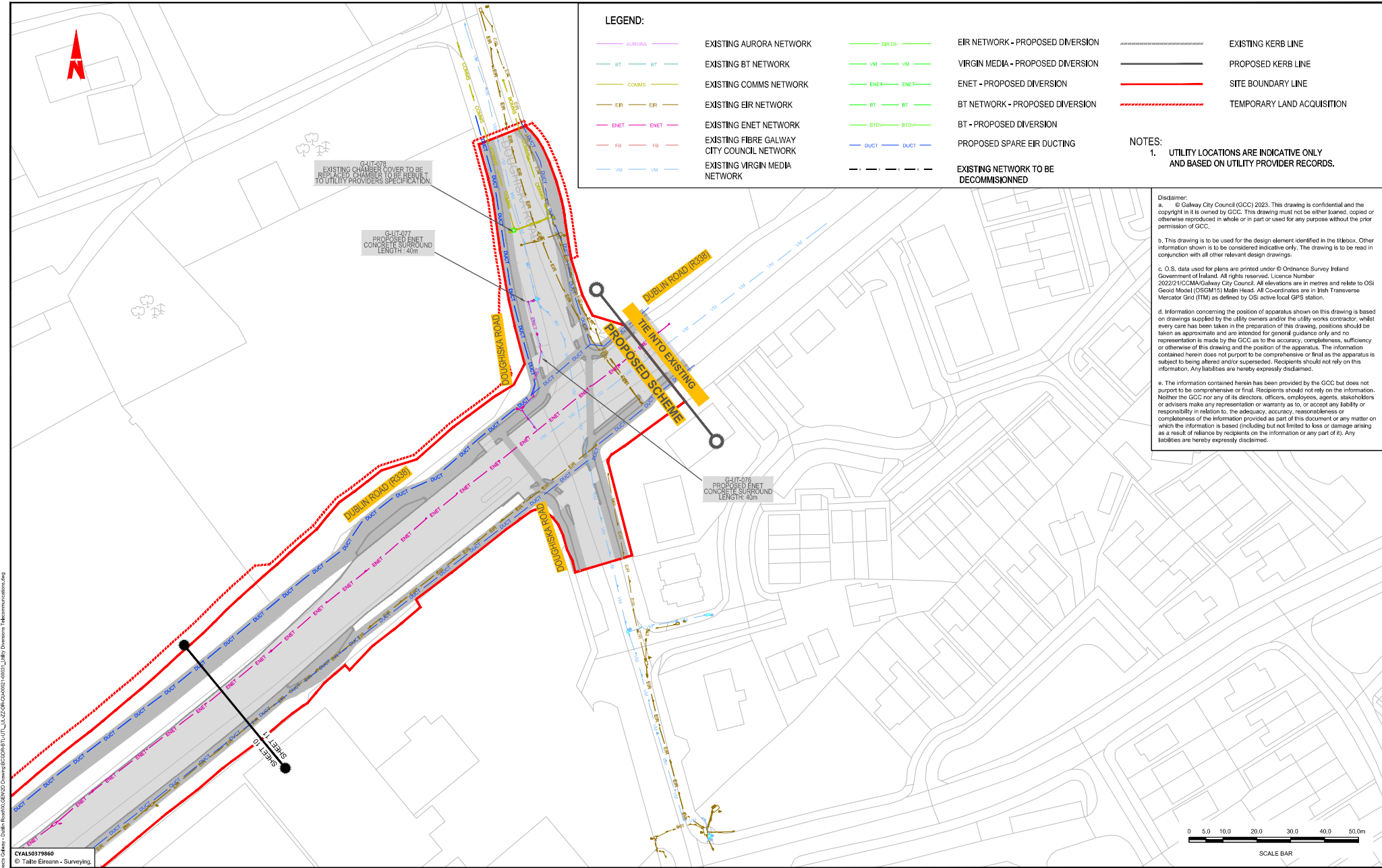

LEGEND:

	AURORA		EXISTING AURORA NETWORK		EIR CV		EIR NETWORK - PROPOSED DIVERSION		EXISTING KERB LINE
	BT		EXISTING BT NETWORK		VM		VIRGIN MEDIA - PROPOSED DIVERSION		PROPOSED KERB LINE
	COMMS		EXISTING COMMS NETWORK		ENET		ENET - PROPOSED DIVERSION		SITE BOUNDARY LINE
	EIR		EXISTING EIR NETWORK		BT		BT NETWORK - PROPOSED DIVERSION		TEMPORARY LAND ACQUISITION
	ENET		EXISTING ENET NETWORK		BTDA		BT - PROPOSED DIVERSION		
	FB		EXISTING FIBRE GALWAY CITY COUNCIL NETWORK		DUCT1		PROPOSED SPARE EIR DUCTING		
	VM		EXISTING VIRGIN MEDIA NETWORK		DUCT2		EXISTING NETWORK TO BE DECOMMISSIONED		

- NOTES:
- UTILITY LOCATIONS ARE INDICATIVE ONLY AND BASED ON UTILITY PROVIDER RECORDS.

Disclaimer:
a. © Galway City Council (GCC) 2023. This drawing is confidential and the copyright in it is owned by GCC. This drawing must not be either loaned, copied or otherwise reproduced in whole or in part or used for any purpose without the prior permission of GCC.
b. This drawing is to be used for the design element identified in the titlebox. Other information shown is to be considered indicative only. The drawing is to be read in conjunction with all other relevant design drawings.
c. O.S. data used for plans are printed under © Ordnance Survey Ireland Government of Ireland. All rights reserved. Licence Number: 2022/21/GCC/M/Galway City Council. All elevations are in metres and relate to OSI Geoid Model (OSGM15) Mean Head. All Co-ordinates are in Irish Transverse Mercator Grid (ITM) as defined by OSI active local GPS station.
d. Information concerning the position of apparatus shown on this drawing is based on drawings supplied by the utility owners and/or the utility works contractor, whilst every care has been taken in the preparation of this drawing, positions should be taken as approximate and are intended for general guidance only and no representation is made by the GCC as to the accuracy, completeness, sufficiency or otherwise of this drawing and the position of the apparatus. The information contained herein does not purport to be comprehensive or final as the apparatus is subject to being altered and/or superseded. Recipients should not rely on this information. Any liabilities are hereby expressly disclaimed.
e. The information contained herein has been provided by the GCC but does not purport to be comprehensive or final. Recipients should not rely on the information. Neither the GCC nor any of its directors, officers, employees, agents, stakeholders or advisers make any representation or warranty as to, or accept any liability or responsibility in relation to, the adequacy, accuracy, reasonableness or completeness of the information provided as part of this document or any matter on which the information is based (including but not limited to loss or damage arising as a result of reliance by recipients on the information or any part of it). Any liabilities are hereby expressly disclaimed.

CYAL50379860
© Taithe Eireann - Surveying.

Notes:
DO NOT SCALE. Use figured dimensions only.
All levels are related to Ordnance Survey Datum, Mean Head.
This drawing is the property of Barry Transportation. It is a confidential document and must not be copied, used, or its contents divulged without prior written consent. This document should not be relied on or used in circumstances other than those for which it was originally prepared. Barry Transportation accepts no responsibility for the document to any other party other than the party by whom it was commissioned.

Rev.	Date	Drawn	Description	Chk'd	Asor'd
001	26/03/24	GFF	BUSL FOR PLANNING	30L	JA

Project Title: BUSCONNECTS GALWAY - DUBLIN ROAD		Status: A1
Drawing Title: UTILITY DIVERSIONS TELECOMMUNICATIONS SHEET 11 OF 11		Rev: C01
Designed: AC	Drawing No: BCDGR-81T-U_L-22-DR-CL-00031	
Drawn: AC	Scale at A1: 1:500	
Approved: SOL	Date: OCT 2023	
Reviewed: JN		